

**LEON COUNTY  
DEPARTMENT OF DEVELOPMENT SUPPORT  
AND ENVIRONMENTAL MANAGEMENT**

**Wednesday, November 20, 2024  
Starting at 10:00 a.m.**

**IN-PERSON AND VIRTUAL PUBLIC MEETING OPTIONS:**

The Development Review Committee (DRC) meeting will be held both in-person and virtually via the Teams teleconference platform.

**In-Person Meeting Location:**

**435 N. Macomb Street, 2<sup>nd</sup> Floor, Renaissance Building, Tallahassee, FL 32301**

*(Please contact the Project Coordinator at least 48 hours in advance of the meeting if attending in person to ensure that social distancing can be maintained in the meeting room.)*

**Teams (virtual) Teleconference Meeting Information:**

Please click the link below to join the webinar:

**Join on your computer, mobile app or room device**

[Click here to join the meeting](#)

Meeting ID: 268 272 225 436

Passcode: uPjwhx

[Download Teams](#) | [Join on the web](#)

**Or call in (audio only)**

[+1 929-352-3425](tel:+19293523425),516599411# United States, New York City

Phone Conference ID: 516 599 411#

[Find a local number](#) | [Reset PIN](#)

[Learn More](#) | [Meeting options](#)

**DEVELOPMENT REVIEW COMMITTEE (DRC) MEETING:**

<b>NO. 1</b>	Project Name:	Killimore Lane Extension
	Project ID#:	LDR24033
	Applicant:	Blueprint Intergovernmental Agency
	Agent:	Martha Hodges, PE   Blueprint IA
	Parcel ID#:	14-36-20-207-000-0
	Location:	Intersection of Velda Dairy and Ox Bottom Roads
	Project Description:	<p>Killimore Lane Extension begins on the east side of Centerville Road at the existing Killimore Lane intersection, runs approximately one-half mile (0.5 mi) east and terminates just to the west of the proposed Welaunee Boulevard.</p> <p>The applicant is requesting a variance from the 35-foot radius to 60-foot returns on the Killimore Lane Extension</p>
Project Coordinator:	<p>Michael Hogan, Environmental Services                  Email: <a href="mailto:hoganm@leoncountyfl.gov">hoganm@leoncountyfl.gov</a>                  Phone: 850-606-1384</p>	

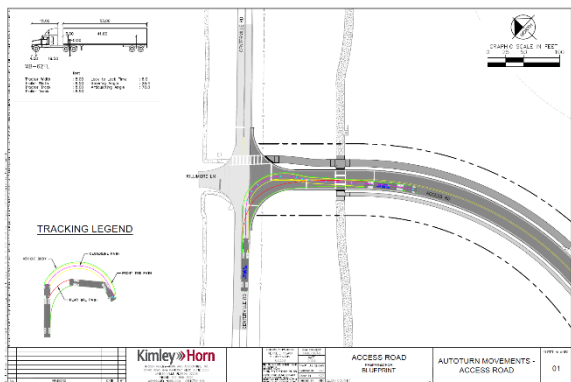

In accordance with the Americans with Disabilities Act and Section 286.26, Florida Statutes, persons needing a special accommodation to participate in this proceeding should contact Mathieu Cavell at Leon County Courthouse, 301 South Monroe Street, Tallahassee, Florida 32301 or [CMR@leoncountyfl.gov](mailto:CMR@leoncountyfl.gov), by written request at least 48 hours prior to the proceeding. Telephone: (850) 606-5300, 1-800-955-8771 (TTY), 1-800-955-8770 (Voice), or 711 via Florida Relay Service. Accommodation Request Forms are available on the website at: <http://LeonCountyFl.gov/ADA>.